

 **TurboTronic**
House Electronics

X12
HAND-HELD VACUUM CLEANER

INSTRUCTION MANUAL



CYCLONE HEND VACUUM CLEANER

TT-X12

www.zline-world.com

WARNINGS AND SAFETY PRECAUTION

Read the instruction manual carefully before use!

Keep this instruction manual for future use.

Children should be supervised to ensure that they do not play with the appliance.

This appliance is designed for domestic use only.

Do not pull on the connection cord, but rather on the plug, to separate the appliance adaptor from the mains.

Do not use outdoor.

Do not leave the appliance unattended when it is switched on, as this may be a source of danger.

Stand the appliance on a table or flat surface.

If the supply adaptor is damaged, it must be replaced by a qualified person in order to avoid a hazard.

Following objects are strictly banned, otherwise the vacuum cleaner will be damaged or fire calamity will be caused, which bring such accidents as human body injuries:

Don't pick up large or sharp broken such as glasses,

Don't pick up reactive liquids (solvent, corrosive, detergent...),

Don't pick up inflammable or explosive substance such as gasoline or alcohol.

Check the device and connections regularly for visible damage.

The device must not be used if the housing is damaged or other damage is present.

Never attempt to open the device or the mains adapter yourself or to replace the connecting cable. Always have repairs to the device carried out by a specialist workshop.

There is considerable danger to the user if repairs are faulty.

Do not trap the mains power adapter cable and when using the adapter, pay attention to where the cable is to prevent any danger of tripping over it.

Keep the cable away from heated surfaces (e.g., cooker and other hot surfaces).

Do not touch the mains adapter and cable with wet hands.

Do not point the vacuum cleaner at persons or animals when in operation.

Only use the mains adapter in a clean and dry environment.

Only use the device with the accessories supplied.

Please keep these instructions in a safe place.

Use only with the provided adaptor.

This appliance is not intended for use by children or the infirm, unless they have been given supervision or instruction concerning use of the appliance by a person responsible for their safety.

When vacuuming liquid spills ensure that the dust canister does not become overfilled, as this will block the filters and may seriously damage the appliance

DESCRIPTION

- 1, Dust tank
- 2, Dust tank release button
- 3, Indicator light
- 4, On/off switch button
- 5, Crevice tool
- 6, Rubber tool
- 7, Charging base
- 8, Adapter



CHARGING

Attention: You may fix the charging base on wall or put on the flat surface.

Put the appliance on the charging base.

Insert the adaptor into the mains socket always make sure that the vacuum is turned off before connecting to the power adaptor.

The indicator light in red color will come on and keep flashing once the device has made contact with the adaptor.

In order to ensure that it is always ready for use, the device should be left on charge with adaptor when not being used.

The adaptor may become warm during charging-this is normal.



INDICATION LIGHT

1, When charging the appliance, The indication in red color will come on and keep flashing..

2, When fully charged. The indication light will keep on in red color

3, When using the appliance. The indication light will be in green color.

4, When the battery is weak. The indication light in green color will keep flashing.

USE AND FUCTION

Do not connect the adaptor when using the appliance

You should regularly check that the nozzle is clean as any foreign object may scratching sensitive floors.

- 1, Inset the crevice nozzle (6) into main unit when cleaning table, car, corner sofa, carpet etc....
- 2, Insert the rubber nozzle into main unit when cleaning water.
- 3, Start the device by pushing the on/off button (4) upward.
- 4, Pushing the on/off switch button (4) downward to turn off the device.

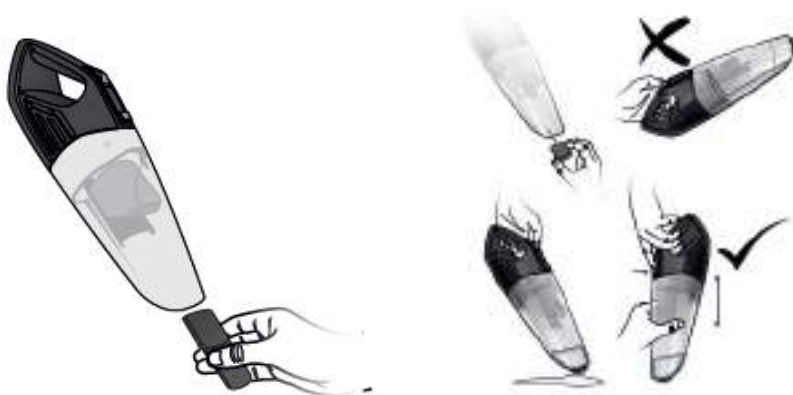

EMPTYING/CLEANING

Careful cleaning of the dust container and filters

1. Remove the whole dust bin by pressing the release button and take the dust container off. (pic1)
2. Pulling out the filters and emptying the contents of the dust container into a suitable vessel or bag. (The filter can be shaken clean or cleaned and rinsed using warm water. Make sure that the parts are dry before they are re-installed.) (pic2)
3. Empty the dust tank. (pic3)

4. Washing the filters under water. (pic4)

5. Re-install the components

Important: Make sure that the parts are dry before they are re-installed.

Put the filter into dust container. Assemble the dust bin to the motor unit following up the opposite procedures for detaching the dust bin.

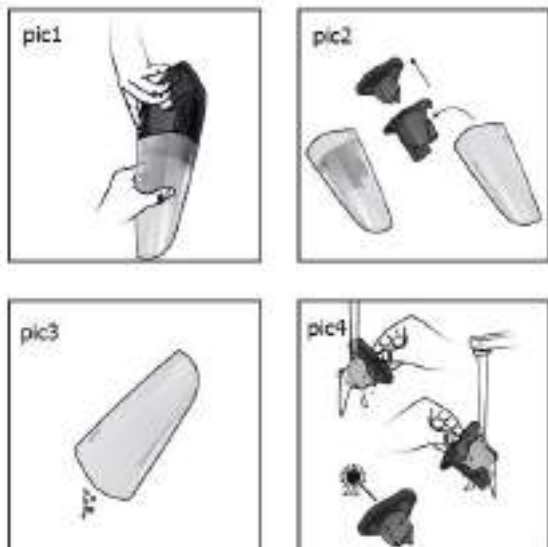

DISPOSAL

If the device is to be disposed, the battery should ideally be removed.

Used battery should be never disposed with household wastes; it should always be taken to a local authority recycling center.

If you cannot disassemble the product yourself the local authority recycling center will dispose of the product for you in an environmentally friendly manner

SERVICING OR REPAIRS

where the product malfunctions or is damaged all inspections and repairs must be carried out by a qualified electrician or technician.